

GC SUPPLIES UK LTD



**Stainless Steel
BSP Screwed
Low Pressure Fittings**

Contents



3

- Introduction

4

- Equal Female 90 Elbow
- Reducing Female 90 Elbow
- Equal M/F 90 Street Elbow

5

- Equal Female 45 Elbow
- Equal M/F 45 Street Elbow
- Equal Female Tee

6

- Reducing Female Tee
- Equal Female Y-Piece

7

- Equal Female Cross
- Barrel Nipple From Pipe
- Weld Nipple From Pipe

8

- Equal Hexagon Nipple
- Reducing Hexagon Nipple

9

- Hexagon Weld Nipple
- Close Taper Nipple
- Running Nipple

10

- Full Socket (Coupling) O.D. Machined
- Half Socket (Coupling) O.D. Machined

11

- Reducing Socket
- Hexagon Socket (Coupling)

12

- Equal M/F Hexagon Adaptor
- Reducing M/F Hexagon Adaptor
- Hexagon Head Plug

13

- Square Head Plug
- Hexagon End Cap
- Hexagon Backnut (Locknut)

14

- Round End Cap
- Hexagon Reducing Bush

15

- Equal Female Cone Seat Union
- M/F Cone Seat Union
- Equal Female Flat Face Union PTFE Gasket

16

- M/F Flat Face Union PTFE Gasket
- M/M Flat Face Union PTFE Gasket
- Union Elbow Flat Face PTFE Gasket

17

- PTFE Union Gasket
- Male Hose Tail
- Female Hose Tail

18

- Male Reducing Hose Tail
- Male Increasing Hose Tail
- Welding Spud

19

- Extended Barrel Nipple
- Extended Weld Nipple
- Backplate Elbow 90

20

- Bulkhead / Tank Connector
- Hose Joiner
- Equal M/F Hex Adaptor NPT(M) x BSP(F)

21

- Equal M/F Hex Adaptor BSPT(M) x NPT(F)
- M/M 90 Degree Bend

Introduction



BSP Screwed Low Pressure Stainless Steel Pipe Fittings

KI (Kingdom) brand high quality CF8M 316 Stainless Steel Castings

100% compliance with the ISO 4144 standard for dimensions, inspection and testing

All KI Pipe Fittings are 100% Pressure Tested at the Factory NOT just batch tested.

All Fittings (with the exceptions listed below) are screwed to ISO 7/1 Rp BSP Parallel Female Threads, ISO 7/1R BSP Taper Male Threads (in both instances, the seal is made on the thread). BSPP Male threads to ISO 228-1 are unsuitable for use with these fittings. Face sealing with "Dowty" Seals is NOT recommended.

20 Bar/g (290 psi/g) pressure rated @ ambient temperatures (see table below)



Pressure-Temp Rating	
Temperature (°C)	No-Shock Maxium Working Pressure (Bar)
-20 to 40	20
100	16.5
150	15
200	14
220	13.5

1. Pressure for intermediate temperatures may be determined by the interpolation method.
 2. Temperatures indicated are those of internal fluid.
 3. Piping loads, stresses and moments are not taken into account.

Back Nuts and Bulkhead/Tank Connectors are threaded to ISO 228-1 BSPP Parallel

Barrel Nipples, Weld Nipples, Close Taper Nipples, Running Nipples, Male Bends and Special Length Barrel/Weld Nipples are all manufactured from Pipe and have a higher pressure rating.

All dimensions given were accurate at the time of publishing and are subject to change without prior notice. If dimensions are critical, please confirm with the Sales office.

K-01

Equal Female 90 Elbow

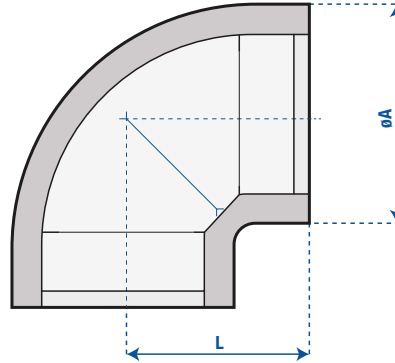

SIZE	øA	L
1/8"	15.5	17.5
1/4"	19	19.5
3/8"	22.5	23.5
1/2"	27.5	27.5
3/4"	33	32.5
1"	40.5	38.5
1-1/4"	50	45.5
1-1/2"	56.5	48.5
2"	70	57.5
2-1/2"	86.5	69.5
3"	100	78.5
4"	126	96.5

K-01A

Reducing Female 90 Elbow

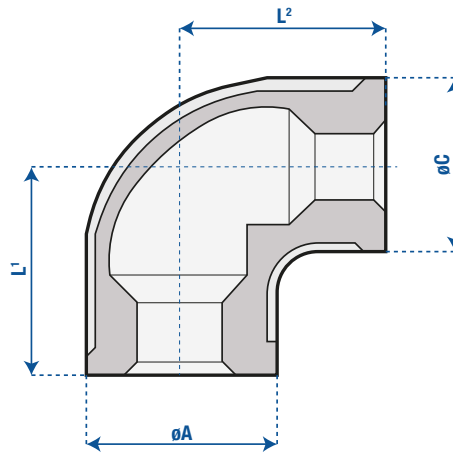

SIZE	øA	øC	L¹	L²
1"x1/2"	40.5	27.5	28.5	30.5
1"x3/4"	40.5	33	34.5	35.5
1-1/4"x1"	50	40.5	40.5	42.5
1-1/2"x1"	56.5	40.5	41.5	45.5

K-04

Equal M/F 90 Street Elbow

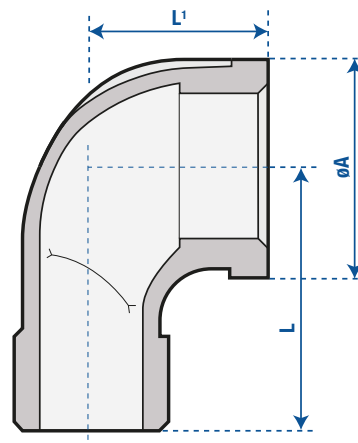

SIZE	øB	L	L¹
1/8"	15.5	26.5	17.5
1/4"	19	27.5	19.5
3/8"	22.5	29.5	23.5
1/2"	27	35.5	27.5
3/4"	32.5	40.5	32.5
1"	40	46.5	38.5
1-1/4"	50	54.5	45.5
1-1/2"	56.5	57.5	48.5
2"	69	70.5	57.5
2-1/2"	86.5	83.5	69.5
3"	100	94.5	78.5
4"	126	115.5	97.5

K-05

Equal Female 45 Elbow

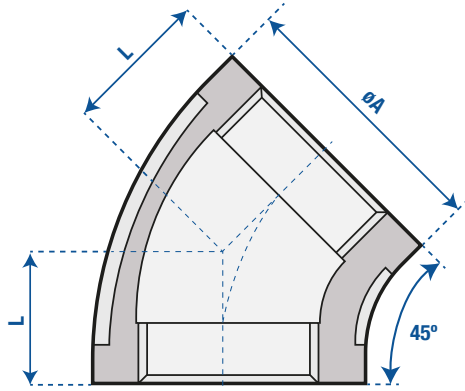

SIZE	$\varnothing A$	L
1/8"	15.5	16.5
1/4"	19	17.5
3/8"	22.5	19.5
1/2"	27.5	21.5
3/4"	33	25.5
1"	40.5	29.5
1-1/4"	50	33.5
1-1/2"	56.5	37.5
2"	70	42.5
2-1/2"	86.5	49.5
3"	100	54.5
4"	126	64.5

K-04A

Equal M/F 45 Street Elbow

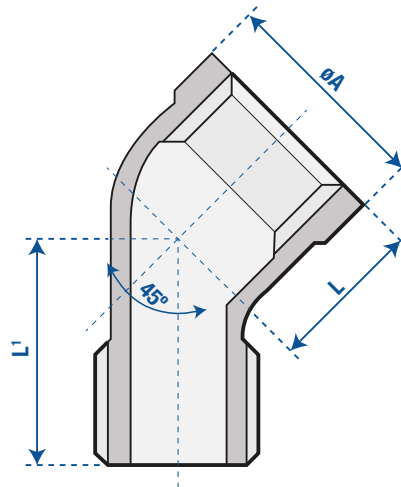

SIZE	$\varnothing A$	L	L'
1/4"	21	17	23
3/8"	25	19	27
1/2"	29	21	31
3/4"	35	25	36
1"	43	29	42
1-1/4"	52	34	49
1-1/2"	58	37	51
2"	71	42	59

K-02

Equal Female Tee

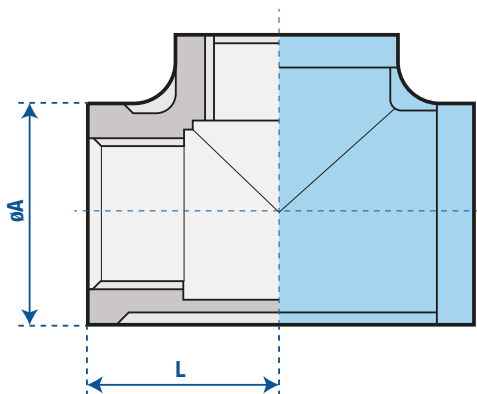

SIZE	$\varnothing A$	L
1/8"	15.5	17.5
1/4"	19	19.5
3/8"	22.5	23.5
1/2"	27.5	27.5
3/4"	33	32.5
1"	40.5	38.5
1-1/4"	50	45.5
1-1/2"	56.5	48.5
2"	70	57.5
2-1/2"	86.5	69.5
3"	100	78.5
4"	126	96.5

K-02A

Reducing Female Tee

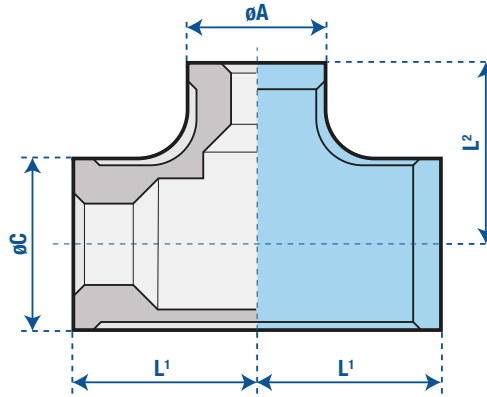

SIZE	$\varnothing A$	$\varnothing C$	L^1	L^2
3/8"x1/8"	15.5	22.5	19.5	20.5
1/2"x1/4"	19	27.5	24.5	24.5
1/2"x3/8"	22.5	27.5	26.5	25.5
3/4"x1/4"	19	33	26.5	27.5
3/4"x1/2"	27.5	33	29.5	30.5
1"x1/4"	19	40.5	27.5	30.5
1"x3/8"	22.5	40.5	30.5	32
1"x1/2"	27.5	40.5	32.5	33.5
1"x3/4"	33	40.5	34.5	35.5
1-1/4"x3/8"	22.5	50	34	36.5
1-1/4"x1/2"	27.5	50	36	38.5
1-1/4"x3/4"	33	50	38.5	40.5
1-1/4"x1"	40.5	50	40.5	42.5
1-1/2"x1/2"	27.5	56.5	36	41.5
1-1/2"x3/4"	33	56.5	38.5	43.5
1-1/2"x1"	40.5	56.5	41.5	45.5
1-1/2"x1-1/4"	50	56.5	45.5	48.5
2"x1/2"	27.5	69	41.5	49.5
2"x3/4"	33	69	41.5	49.5
2"x1"	40	69	44.5	51.5
2"x1-1/4"	50	70	48.5	54.5
2x1-1/2"	56.5	70	52.5	55.5

K-02C

Equal Female Y-Piece

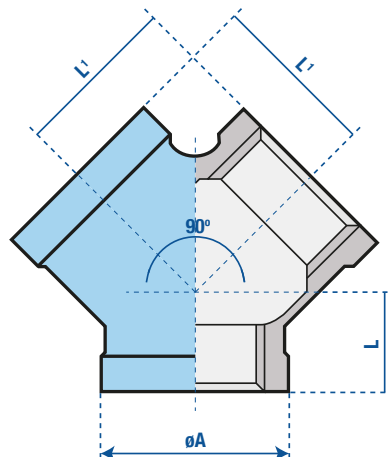

SIZE	$\varnothing A$	L	L^1
1/4"	21	13	19
3/8"	25	14	23
1/2"	29	18	27
3/4"	35	20	32
1"	43	23	38
1-1/4"	52	28	46
1-1/2"	58	30	48
2"	71	34	57

K-03

Equal Female Cross

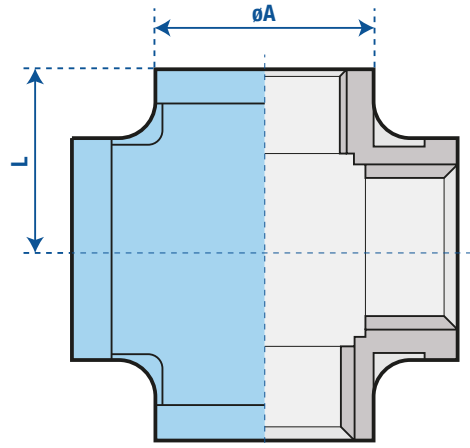

SIZE	ØA	L
1/8"	15.5	17.5
1/4"	19	19.5
3/8"	22.5	23.5
1/2"	27	27.5
3/4"	32.5	32.5
1"	40	38.5
1-1/4"	50	45.5
1-1/2"	56.5	48.5
2"	69	57.5
2-1/2"	86.5	69.5
3"	100	78.5
4"	126	96.5

K-07B

Barrel Nipple From Pipe

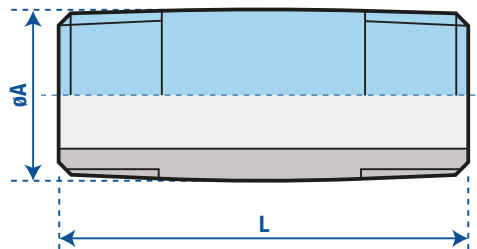

SIZE	ØA	L
1/8"	10.2	40
1/4"	13.5	40
3/8"	17.2	40
1/2"	21.3	60
3/4"	26.9	60
1"	33.7	60
1-1/4"	42.4	80
1-1/2"	48.3	80
2"	60.3	100
2-1/2"	76.1	100
3"	88.9	120
4"	114.3	120
5"	139.7	150
6"	165.1	155

K-07C

Weld Nipple From Pipe

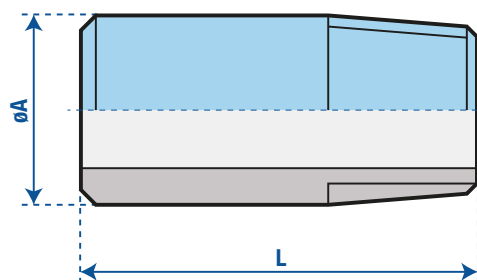

SIZE	ØA	L
1/8"	10.2	30
1/4"	13.5	30
3/8"	17.2	30
1/2"	21.3	35
3/4"	26.9	40
1"	33.7	40
1-1/4"	42.4	50
1-1/2"	48.3	50
2"	60.3	50
2-1/2"	76.1	60
3"	88.9	70
4"	114.3	80
5"	139.7	90
6"	165.1	100

K-071

Equal Hexagon Nipple

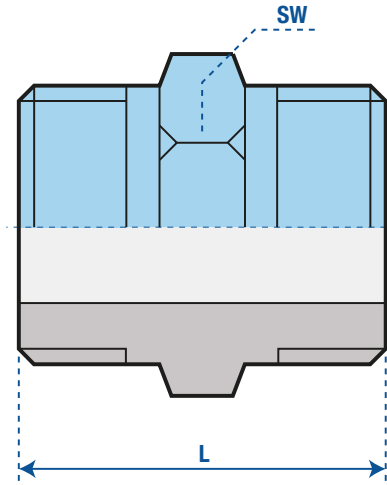

SIZE	L	SW
1/8"	23.6	12
1/4"	27.8	16
3/8"	28	19
1/2"	34	21.6
3/4"	40	30
1"	46	36
1-1/4"	52.5	46
1-1/2"	54	50
2"	62	64.5
2-1/2"	70	79.5
3"	78.4	90
4"	94	120

K-07A

Reducing Hexagon Nipple

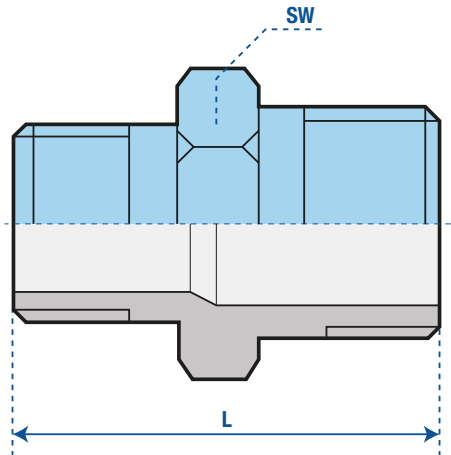

SIZE	L	SW
1/4"x1/8"	25.5	16
3/8"x1/8"	26	18
3/8"x1/4"	28.5	18
1/2"x1/8"	34	26
1/2"x1/4"	32	24
1/2"x3/8"	37	24
3/4"x1/4"	37	30
3/4"x3/8"	34.5	30
3/4"x1/2"	38	30
1"x1/4"	39	30
1"x3/8"	40	35
1"x1/2"	41	35
1"x3/4"	42	36
1-1/4"x3/8"	46	36

SIZE	L	SW
1-1/4"x1/2"	48	46
1-1/4"x3/4"	45.5	46
1-1/4"x1"	48.5	46
1-1/2"x1/2"	49	46
1-1/2"x3/4"	53	50
1-1/2"x1"	48.5	50
1-1/2"x1-1/4"	51	50
2"x1/2"	52	50
2"x3/4"	56	63
2"x1"	57	63
2"x1-1/4"	55.5	63
2"x1-1/2"	55.5	65
2-1/2"x3/4"	63	65
2-1/2"x1"	63	80

SIZE	L	SW
2-1/2"x1-1/4"	66	80
2-1/2"x1-1/2"	57.5	80
2-1/2"x2"	62	80
3"x1"	69	80
3"x1-1/4"	72	95
3"x1-1/2"	72	95
3"x2"	66	95
3"x2-1/2"	68	95
4"x2"	82	125
4"x2-1/2"	74	120
4"x3"	77	120

K-07E

Hexagon Weld Nipple

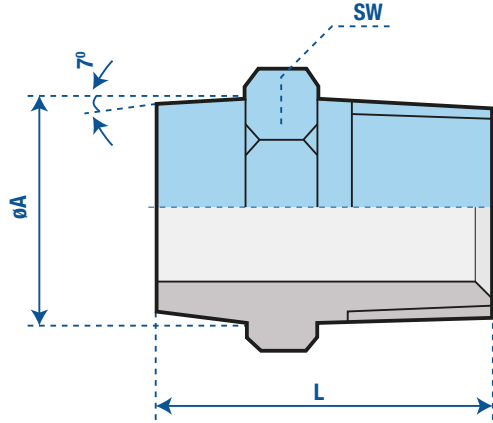

SIZE	øA	L	SW
1/4"	14	30.6	14.3
3/8"	17.2	31.8	17.5
1/2"	20.7	36.4	22.2
3/4"	26.6	38.1	28.6
1"	32.9	42.9	34.9
1-1/4"	41.3	49.2	42.8
1-1/2"	48.8	54	50.8
2"	60.3	55.6	63.5

K-07CTN

Close Taper Nipple

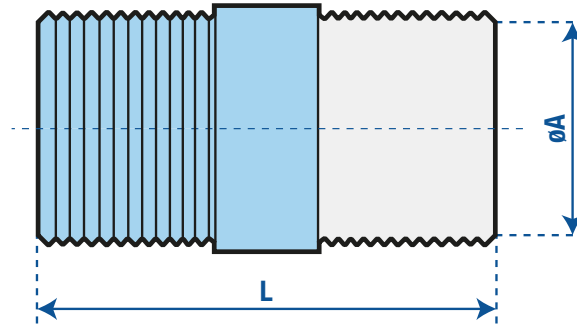

SIZE	øA	L
1/8"	10.2	27
1/4"	13.5	27
3/8"	17.2	28
1/2"	21.3	37
3/4"	26.9	39
1"	33.7	46
1-1/4"	42.4	51
1-1/2"	48.3	51
2"	60.3	60
2-1/2"	76.1	69
3"	88.9	70
4"	114.3	80

K-07RGN

Running Nipple

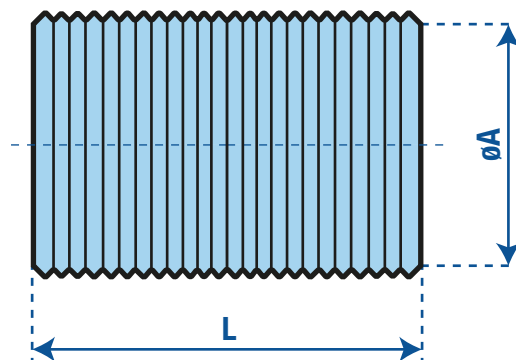

SIZE	øA	L
1/8"	10.2	18
1/4"	13.5	21
3/8"	17.2	22
1/2"	21.3	28
3/4"	26.9	33
1"	33.7	36
1-1/4"	42.4	40
1-1/2"	48.3	40
2"	60.3	49
2-1/2"	76.1	55
3"	88.9	58
4"	114.3	70

K-012E

Full Socket (Coupling) O.D. Machined

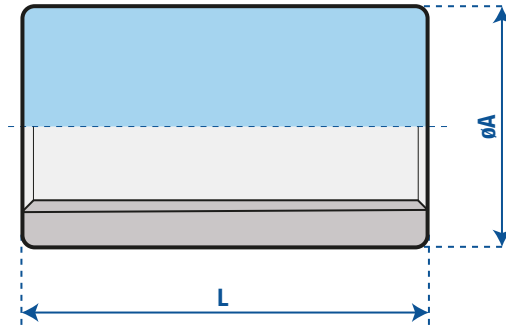

SIZE	ØA	L
1/8"	15	17
1/4"	18.5	25
3/8"	21.3	26
1/2"	26.4	34
3/4"	31.8	36
1"	39.5	43
1-1/4"	48.3	48
1-1/2"	54.5	48
2"	66.5	56
2-1/2"	82.3	65
3"	95	71
4"	122	83
5"	153	89
6"	175	92.5

K-012F

Half Socket (Coupling) O.D. Machined

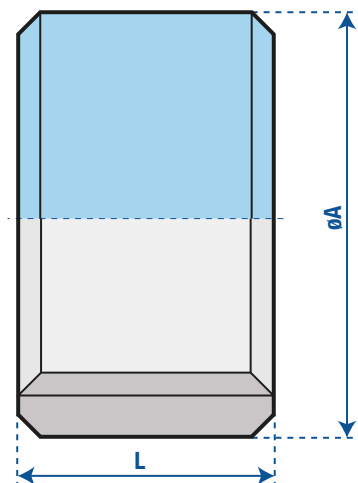

SIZE	ØA	L
1/8"	15	10
1/4"	18.5	8
3/8"	21.3	12
1/2"	26.4	15
3/4"	31.8	17
1"	39.5	20
1-1/4"	48.3	22
1-1/2"	54.5	22
2"	66.5	26
2-1/4"	75	38
2-1/2"	82.3	31
3"	95	34
4"	122	39

K-012A Reducing Socket

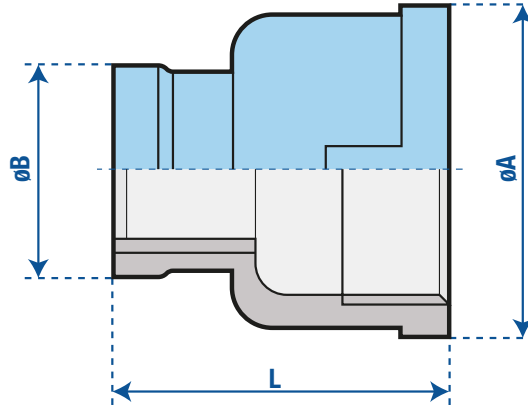

SIZE	$\varnothing A$	$\varnothing B$	L
1/4"x1/8"	19	15.5	26
3/8"x1/8"	22.5	15.5	27
3/8"x1/4"	22.5	19	27
1/2"x1/8"	29	17	34
1/2"x1/4"	27	19	35
1/2"x3/8"	27	22.5	35
3/4"x1/8"	36.7	17	38
3/4"x1/4"	36.7	21	38
3/4"x3/8"	32.5	22.5	37
3/4"x1/2"	32.5	27	37
1"x1/4"	43	21.2	42
1"x3/8"	43	25.4	42
1"x1/2"	40	27	43
1"x3/4"	40	32.5	43
1-1/4"x3/8"	52	25.4	48

SIZE	$\varnothing A$	$\varnothing B$	L
1-1/4"x1/2"	52	30	48
1-1/4"x3/4"	50	32.5	49
1-1/4"x1"	50	40	49
1-1/2"x1/2"	59	29	51
1-1/2"x3/4"	59	35.5	49
1-1/2"x1"	56.5	40	53
1-1/2"x1-1/4"	56.5	50	53
2"x1/2"	72	28	50.5
2"x3/4"	72	33	51
2"x1"	72	41	56
2"x1-1/4"	69	50	59
2"x1-1/2"	69	56.5	59
2-1/2"x1"	87	43	60
2-1/2"x1-1/4"	85	52	60
2-1/2"x1-1/2"	85	57	60

SIZE	$\varnothing A$	$\varnothing B$	L
2-1/2"x2"	85	69.4	61
3"x1"	100	43.2	62
3"x1-1/4"	100	52.7	62
3"x1-1/2"	100	56.6	62
3"x2"	100	70	62
3"x2-1/2"	100	87	62
4"x2"	129	70	65
4"x2-1/2"	128	86.2	65
4"x3"	128	105	65

K-012K Hexagon Socket (Coupling)

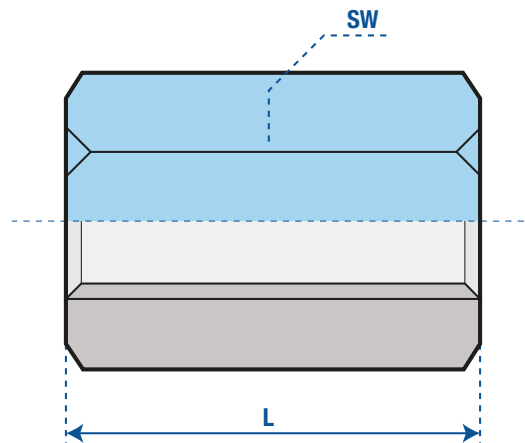

SIZE	L	SW
1/4"	25	17
3/8"	26	21
1/2"	34	26
3/4"	36	32
1"	43	38

K-017

Equal M/F Hexagon Adaptor

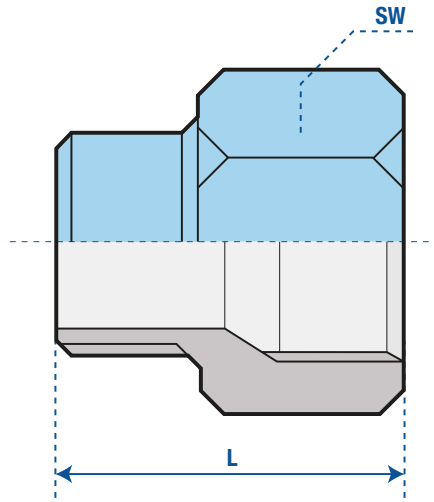
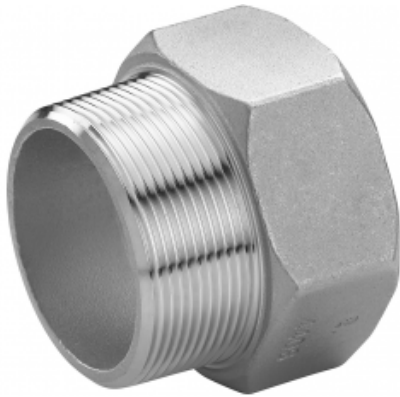

SIZE	L	SW
1/4"	28.5	17
3/8"	31	21
1/2"	37.5	26
3/4"	41	32
1"	46	38

K-09A

Reducing M/F Hexagon Adaptor

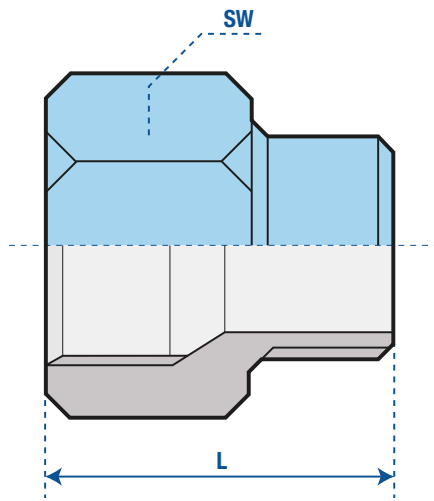

SIZE	L	SW
1/8"x1/4"	27	17
1/4"x3/8"	30.5	21
1/4"x1/2"	34	26
3/8"x1/2"	34.5	26
1/2"x3/4"	38.5	32
1/2"x1"	41	38
3/4"x1"	44	38
1"x1-1/4"	47	50
1"x1-1/2"	42.5	50
1"x2"	51	68
1-1/4"x1-1/2"	50	54
1-1/4"x2"	53	68
1-1/2"x2"	54	68

K-08

Hexagon Head Plug

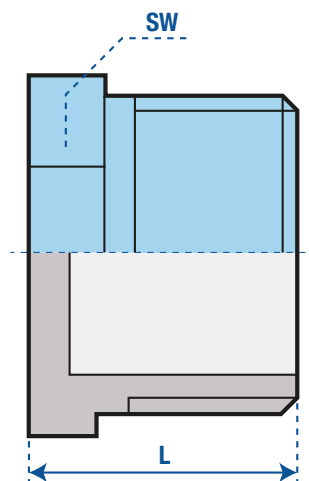

SIZE	L	SW
1/8"	17	12
1/4"	17.5	16
3/8"	18	20
1/2"	21	24
3/4"	22.5	30
1"	25.5	36
1-1/4"	28.5	46
1-1/2"	28.5	50
2"	33.5	65
2-1/2"	37	80
3"	41	95
4"	48	120

K-08B

Square Head Plug

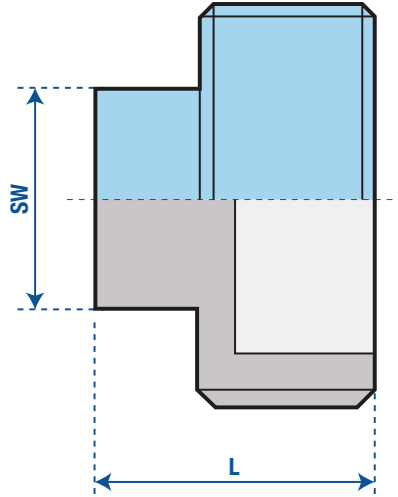

SIZE	L	SW
1/8"	16.5	6x6
1/4"	20	9x9
3/8"	24	11x11
1/2"	20.5	13x13
3/4"	23	16x16
1"	27.5	21x21
1-1/4"	30	24x24
1-1/2"	31	27x27
2"	36.5	34x34
2-1/2"	40.5	41x41
3"	43.5	46x46
4"	54	60x60

K-010

Hexagon End Cap

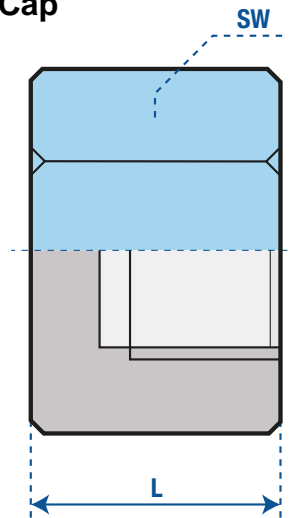

SIZE	L	SW
1/4"	17	18
3/8"	19	21
1/2"	20	27
3/4"	24	30
1"	25	38
1-1/4"	28	50
1-1/2"	28	55
2"	34	70
2-1/2"	40	92
3"	45	109
4"	50	132

K-011

Hexagon Backnut (Locknut)

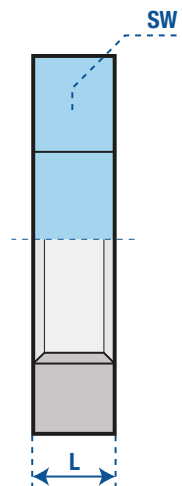

SIZE	L	SW
1/8"	6.2	14.6
1/4"	7	23
3/8"	8	26
1/2"	10	31
3/4"	11	37
1"	10	46
1-1/4"	11	55
1-1/2"	12	63
2"	13	76
2-1/2"	16	95
3"	19	105
4"	20	131

K-010A

Round End Cap

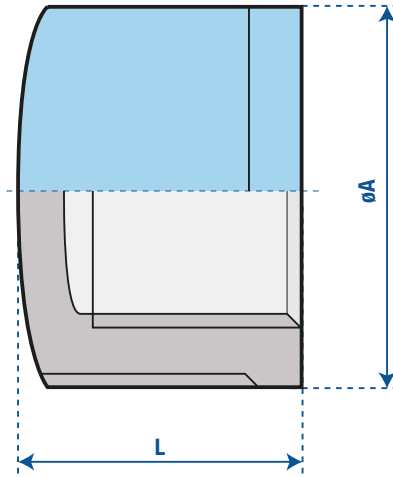

SIZE	ØA	L
1/8"	15.5	13
1/4"	19	16.5
3/8"	22.5	17
1/2"	27	21.5
3/4"	32.5	23
1"	40	26.5
1-1/4"	50	29.5
1-1/2"	56.5	29.5
2"	69	34
2-1/2"	86.5	39
3"	100	42.5
4"	126	49

K-09

Hexagon Reducing Bush

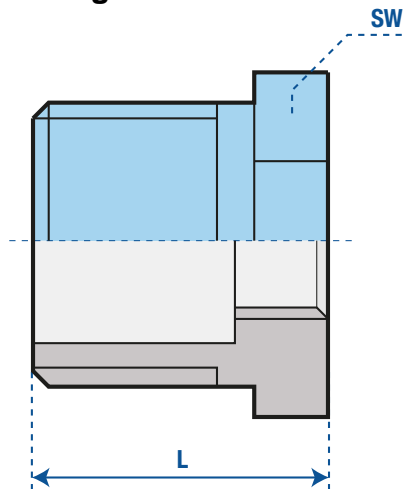

SIZE	L	SW
1/4"x1/8"	15.2	16
3/8"x1/8"	16.5	18
3/8"x1/4"	16.5	18
1/2"x1/8"	21	26
1/2"x1/4"	21	26
1/2"x3/8"	21	26
3/4"x1/8"	24	30
3/4"x1/4"	24	30
3/4"x3/8"	24	30
3/4"x1/2"	24	30
1"x1/4"	27	35
1"x3/8"	27	35
1"x1/2"	27	35
1"x3/4"	27	35
1-1/4"x1/4"	30	45

SIZE	L	SW
1-1/4"x3/8"	30	45
1-1/4"x1/2"	30	45
1-1/4"x3/4"	30	45
1-1/4"x1"	30	45
1-1/2"x3/8"	38	52
1-1/2"x1/2"	38	52
1-1/2"x3/4"	38	52
1-1/2"x1"	29.5	50
1-1/2"x1-1/4"	29.5	50
2"x1/2"	36	63
2"x3/4"	36	63
2"x1"	36	63
2"x1-1/4"	34	65
2"x1-1/2"	34	65
2-1/2"x1/2"	45	81

SIZE	L	SW
2-1/2"x1"	45	81
2-1/2"x1-1/4"	45	81
2-1/2"x1-1/2"	36	80
2-1/2"x2"	36	80
3"x1/2"	46.5	80
3"x1"	46.5	94.5
3"x1-1/4"	46.5	94.5
3"x1-1/2"	47	95
3"x2"	40	95
3"x2-1/2"	40	95
4"x1"	51.5	120
4"x1-1/4"	51.5	120
4"x1-1/2"	51.5	120
4"x2"	52	120
4"x2-1/2"	46	120

SIZE	L	SW
4"x3"	46	120
5"x4"	54	140
6"x4"	55	164

K-06

Equal Female Cone Seat Union

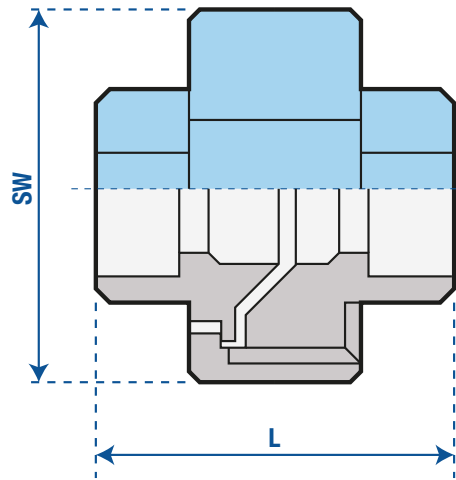

SIZE	L	SW
1/8"	30.5	24
1/4"	34	30
3/8"	37	35
1/2"	40.5	41
3/4"	43	48
1"	50.5	54
1-1/4"	54.5	65
1-1/2"	58.5	72
2"	65.5	88
2-1/2"	76	109
3"	84	122
4"	111	150

K-06B

M/F Cone Seat Union

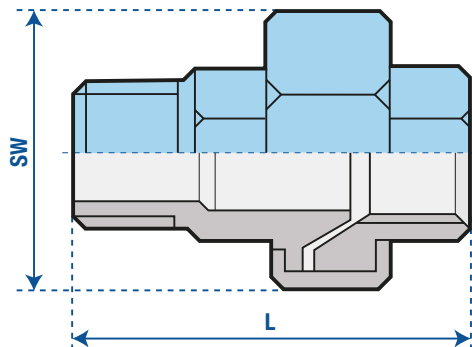

SIZE	L	SW
1/4"	45	30
3/8"	48.5	35
1/2"	55.5	41
3/4"	59	48
1"	69	54
1-1/4"	75.5	65
1-1/2"	79.5	72
2"	91	88
2-1/2"	103.5	109
3"	114.5	122
4"	147.5	150

K-06A

Equal Female Flat Face Union PTFE Gasket

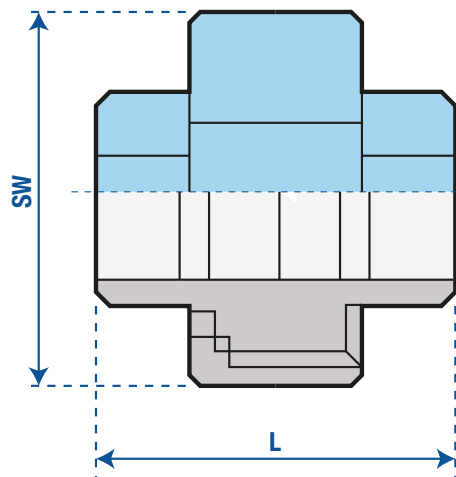

SIZE	L	SW
1/4"	34	30
3/8"	37	35
1/2"	40.5	41
3/4"	43	48
1"	50.5	54
1-1/4"	54.5	65
1-1/2"	58.5	72
2"	65.5	88
2-1/2"	76	109
3"	84	122

K-06C

M/F Flat Face Union PTFE Gasket

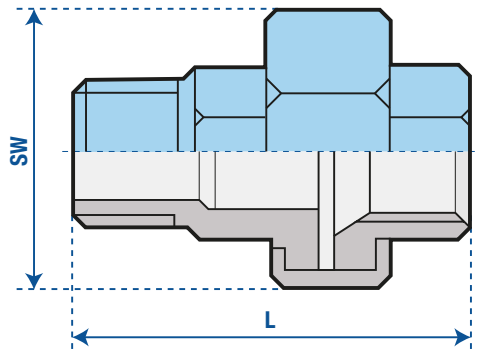

SIZE	L	SW
1/4"	45	30
3/8"	48.5	35
1/2"	55.5	41
3/4"	59	48
1"	69	54
1-1/4"	75.5	65
1-1/2"	79.5	72
2"	91	88
2-1/2"	103.5	109
3"	114.5	122

K-06K

M/M Flat Face Union PTFE Gasket

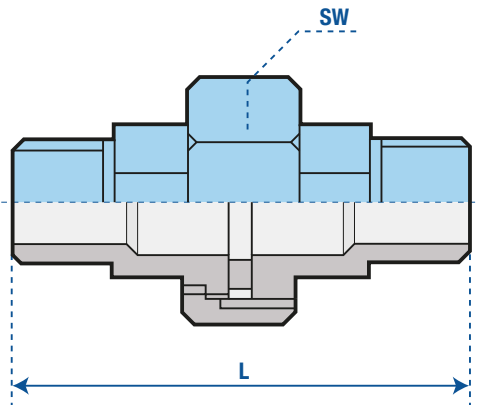

SIZE	L	SW
1/4"	61	30
3/8"	62.5	35
1/2"	73	42
3/4"	82	47
1"	90	53
1-1/4"	104	71
1-1/2"	109.6	78
2"	118	92

K-014A

Union Elbow Flat Face PTFE Gasket

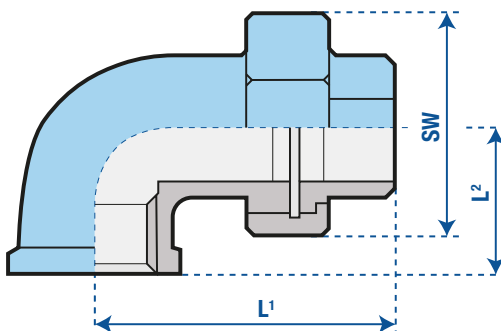

SIZE	L ¹	L ²	SW
1/4"	46.2	21	30
3/8"	49	25	35
1/2"	56	28	42
3/4"	62.7	33	47
1"	68	38	53
1-1/4"	79.5	45	71
1-1/2"	88	50	78
2"	93.8	58	92

K-06G

PTFE Union Gasket

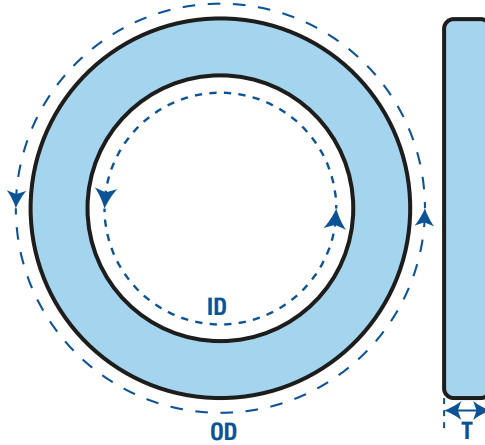
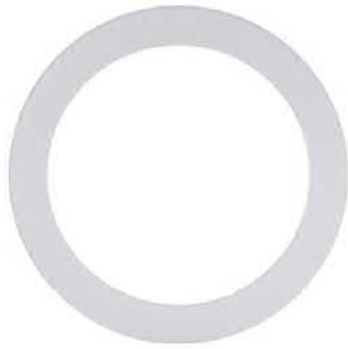

SIZE	OD	ID	T
1/4"	23	14	1.5
3/8"	27	17.5	1.5
1/2"	33	22	1.5
3/4"	39	30	1.5
1"	44.5	35.5	1.5
1-1/4"	55	44	1.5
1-1/2"	61.5	49	1.5
2"	76	62	1.5
2-1/2"	93	76.5	1.5
3"	107	87	1.5

K-07D

Male Hose Tail

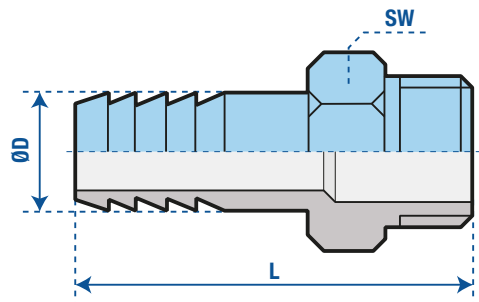

SIZE	ØD	L	SW
1/8"	4	45	12.5
1/4"	6.35	47	16.5
3/8"	9.52	55	20
1/2"	12.7	64	23.5
3/4"	19.05	68	31
1"	25.4	71	38.5
1-1/4"	31.75	80	46
1-1/2"	38.1	95	52
2"	50.8	105	62
2-1/2"	63.5	107	80
3"	76.1	112	91
4"	101.6	130	116.5

K-013

Female Hose Tail

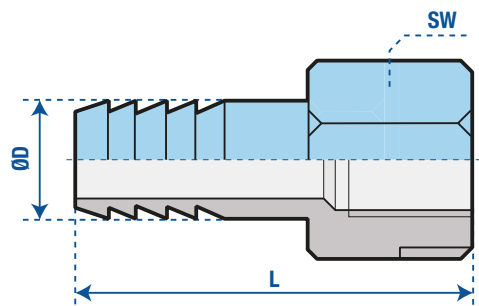

SIZE	ØD	L	SW
1/4"	6.35	42	19
3/8"	9.52	53	22
1/2"	12.7	62	27
3/4"	19.05	63.5	32
1"	25.4	66	38
1-1/4"	31.75	74	50
1-1/2"	38.1	87.5	55.5
2"	50.8	94.5	67.5

K-07DR Male Reducing Hose Tail

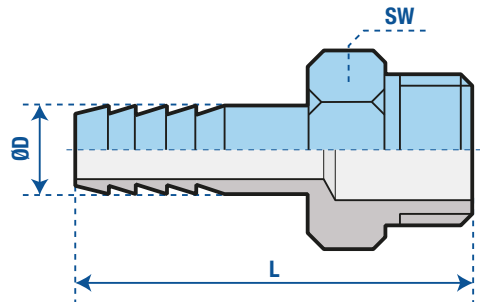

SIZE	ØD	L	SW
1/4"	4	47	16.5
3/8"	6.35	53	20
1/2"	6.35	65	23.5
1/2"	9.52	65	23.5
3/4"	12.7	68	31
1"	12.7	72	38.5
1"	19.05	72	38.5
1-1/4"	25.4	82	46
1-1/2"	25.4	95	52
2"	25.4	106	62
2"	38.1	106	62

K-07DI Male Increasing Hose Tail

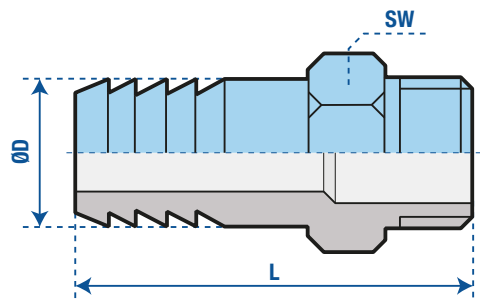

SIZE	ØD	L	SW
1/8"	6.35	45	12.5
1/4"	8	47	16.5
1/4"	9.52	47	16.5
1/4"	12.7	47	16.5
3/8"	12.7	55	20
1/2"	16	64	23.5
1/2"	19.05	64	23.5
3/4"	25.4	70	31
1"	31.75	70	38.5
2"	57	100	62

K-016 Welding Spud

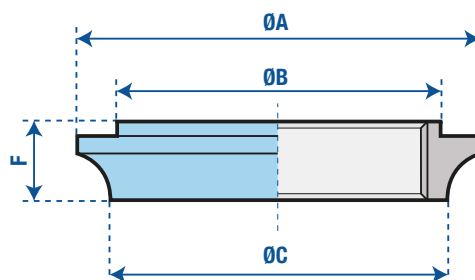

SIZE	ØA	ØB	ØC	F
1/2"	44.5	28.8	27.9	14.9
3/4"	48.5	33.8	33	16.9
1"	56.6	42.9	42	19.7
1-1/4"	65.5	49.1	51.9	19
1-1/2"	71.5	55.5	56.5	20.1
2"	86	68	71	22

K-07BL Extended Barrel Nipple

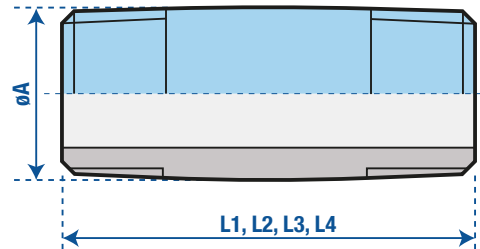
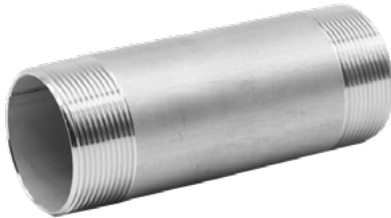

SIZE	ØA	L1	L2	L3	L4
1/8"	10.2	-	100	-	-
1/4"	13.5	75	100	150	200
3/8"	17.2	75	100	150	200
1/2"	21.3	75	100	150	200
3/4"	26.9	75	100	150	200
1"	33.7	75	100	150	200
1-1/4"	42.4	-	100	150	200
1-1/2"	48.3	-	100	150	200
2"	60.3	-	-	150	200

K-07CL Extended Weld Nipple

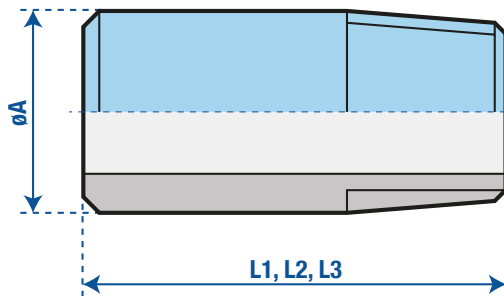

SIZE	ØA	L1	L2	L3
1/4"	13.5	75	100	150
3/8"	17.2	75	100	150
1/2"	21.3	75	100	150
3/4"	26.9	75	100	150
1"	33.7	75	100	150
1-1/4"	42.4	75	100	150
1-1/2"	48.3	75	100	150
2"	60.3	75	100	150

K-01C Backplate Elbow 90

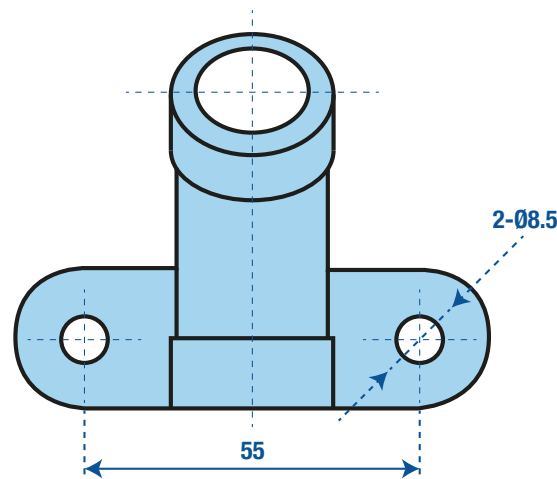

SIZE	Length
1/2"	27.7

K-BTC

Bulkhead / Tank Connector

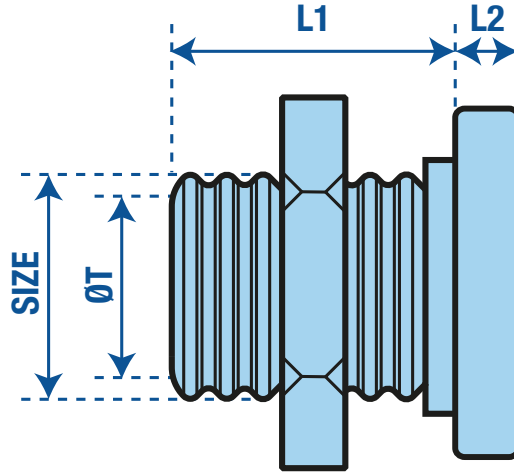

SIZE	ØT	L1	L2
1/2"	3/8"	50	10
3/4"	1/2"	50	10
1"	3/4"	50	10
1-1/4"	1"	60	12
1-1/2"	1-1/4"	60	12
2"	1-1/2"	60	12

K-HJ

Hose Joiner

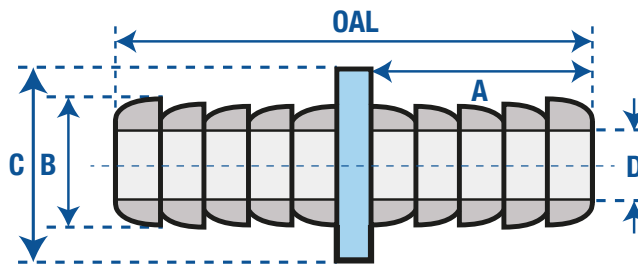

SIZE	OAL	A	B	C	D
1/4"	41	18	6.35	9.5	3.5
5/16"	41	18	8	12	5
3/8"	55	25	9.52	15	6
1/2"	65	30	12.7	18	8.5
5/8"	65	30	16	21	12
3/4"	65	30	19.05	25	14
1"	65	30	25.4	31	19

K-017 NT/BP

Equal M/F Hex Adaptor NPT(M) x BSP(F)

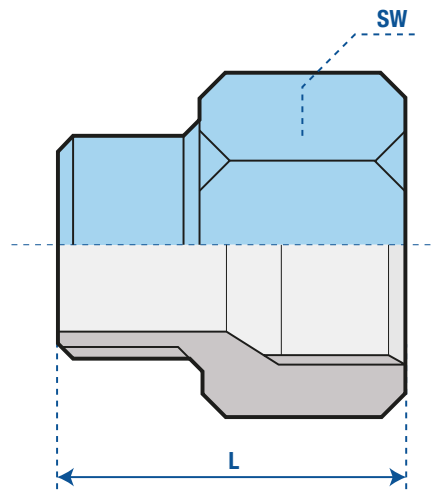
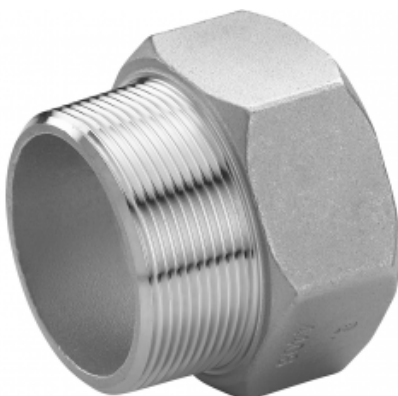

SIZE	L	SW
1"	46	38
1-1/4"	49	50
1-1/2"	51	54
2"	57	68

[Back to Table of Contents](#)

K-017 BT/NT

Equal M/F Hex Adaptor BSPT(M) x NPT(F)

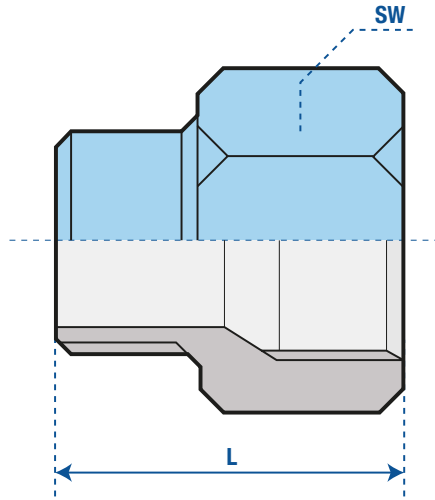

SIZE	L	SW
1"	46	38
1-1/4"	49	50
1-1/2"	51	54
2"	57	68

K-07DB M/M 90 Degree Bend

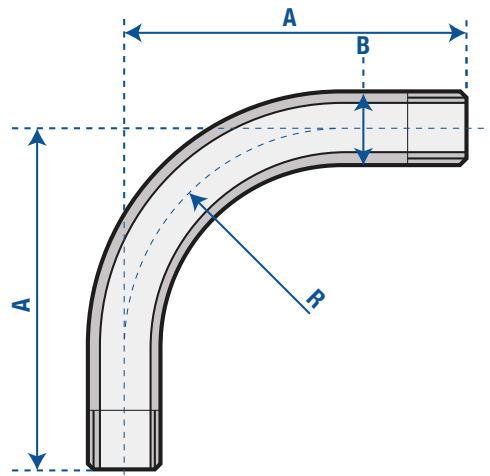

SIZE	A	B	R
1/2"	106	21.3*2.3	50
3/4"	116	26.6*2.3	60
1"	156	33.4*2.8	80
1-1/4"	161	42.1*2.8	100
1-1/2"	171	48.3*2.8	100
2"	216	60.3*3.3	125