

## Screwed Double Window Sight Glass



- ASTM A351 CF8M 316 Stainless Steel construction.
- PTFE Glass Seals. Tempered Soda Lime Glass.
- Swinging Flap to indicate Flow.
- -20 / + 150 Deg C temperature rated. 10 Bar/g pressure rated.
- Available in BSP Screwed Female only (can be machined to Socket Weld)

A versatile, cost effective solution where visual flow indication is required within the pipeline construction.

### 3.1 Material Certificates available.

**Test standard – API 598**

**Available size range: 1/2" - 2"**

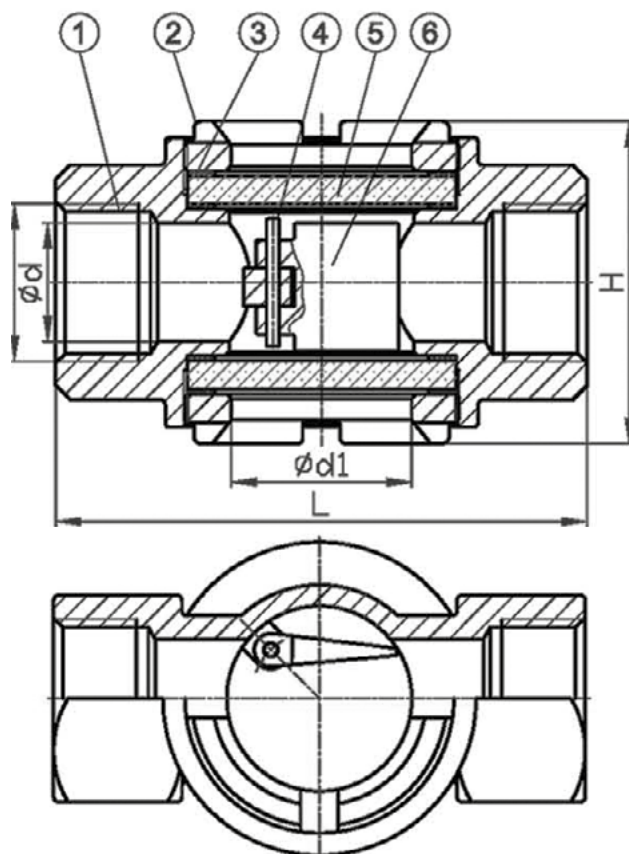

Item	Part	Material	Qty.
1	Body	CF8M	1
2	Cap	CF8M	1
3	Gasket	PTFE	1
4	Stem	SUS316	1
5	Glass	Soda Lime Glass	1
6	Indicator	CF8M	1

SIZE	d	d1	L	H
1/2"	15	38	112	68
3/4"	20	38	112	68
1"	25	38	112	68
1-1/4"	32	45	145	110
1-1/2"	40	45	145	110
2"	50	55	168	131