

## 2-Pce Full Bore Spring Handle Ball Valve

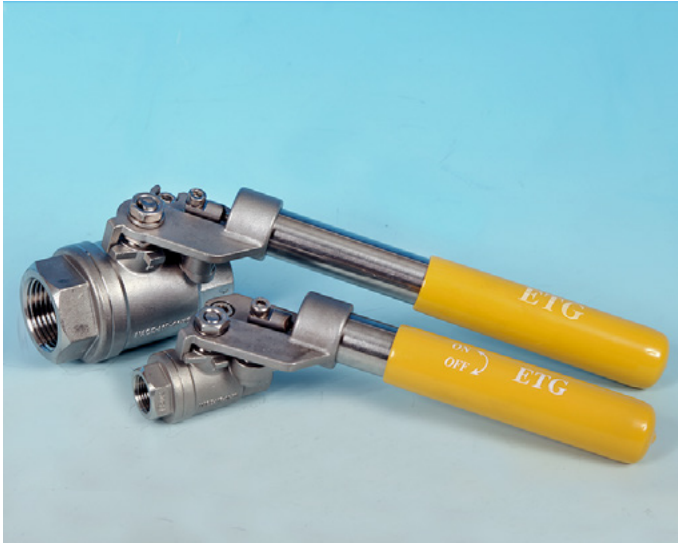

- ASTM A351 CF8M 316 Stainless Steel construction, 316 Trim.
- PTFE Seats and Seals. 2000 psi/g Pressure rated.
- -20 / + 180 Deg C Temperature rated.
- Fully Adjustable Spring Tension. Nace compliant.
- BSP End Connections.

Fail Close Spring Lever or "Dead Man's" Lever Ball Valves are used on applications where there can be no chance of the valve being left in an open position on hazardous and expensive product applications such as fuelling stations etc.

**The Spring is enclosed within the tubular handle of the valve thus preventing possible finger trap hazards.**

**Full material Test Certificates available.**

**Test standard – API 598**

**BSP Ends - BSPP ISO 228/1**

**Available size range: 1/4" - 2"**

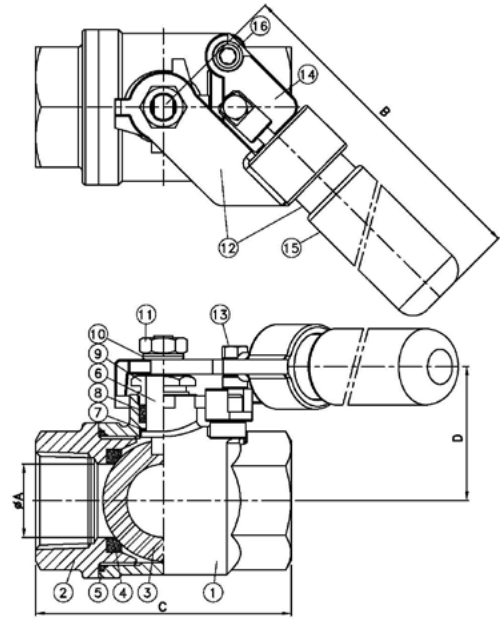
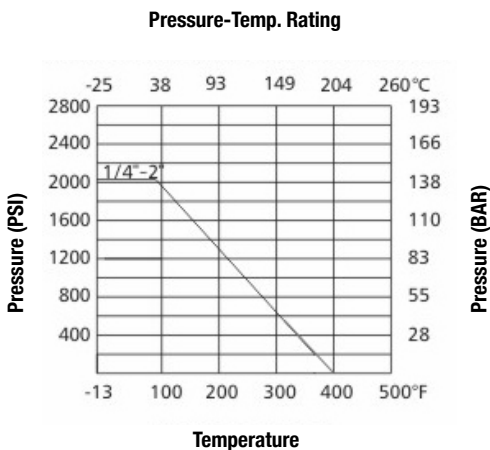

Item	Part	Material
1	Body	A351 CF8M
2	End Cap	A351 CF8M
3	Ball	A351 CF8M Gr.CF8M
4	Ball Seat	R-PTFE (15%)
5	Body Seal	PTFE
6	Stem	A276 TYPE 316
7	Thrust Washer	R-PTFE (15%)
8	Stem Packing	PTFE
9	Gland Nut	SUS 304
10	Stem Washer	SUS 304
11	Stem Nut	SUS 304
12	Handle	A351-CF8 & S.S.
13	Handle Hex	SUS 304
14	Handle Flange	A351-CF8
15	Handle Sleeve	VINYL
16	Handle Bolt	SUS 304

SIZE	øA	B	C	D	WT/KG
1/4"	11.2	184	57	29.5	0.68
3/8"	12.5	184	57	29.5	0.65
1/2"	15	184	66.1	32.7	0.81
3/4"	20	184	75.6	36.6	0.96
1"	25	234	87.2	45.2	1.35
1-1/4"	32	330	97	53.5	2.22
1-1/2"	38	330	113.2	59.5	3.18
2"	50	330	134	71.3	4.38